



Carbon Slider Potentiometers

58 mm travel

Types
CIPGST 2.58M
PGST 2.58M
CIPGST 2.58S
PGST 2.58S

Mechanical data

Travel: 58 mm
 Operating force: $0.7 \div 2$ N
 Permissible force at end stop: 50 N max
 Permissible lateral force on spindle, perpendicular to the direction of movement: 20 N max
 Permissible axial force on spindle, push and pull: 50 N (5 sec max)
 Permissible torque on spindle: 30 Ncm max
 Tap: Z2 at 50% of travel
 Weight: ~12 g

Optional features

- Central click
- Additional fixing tag, for CIPGST2.58M type only

Electrical data

Rated dissipation @ 40°C: 0,4 W linear law
 0,2 W non-linear law
 Limiting element voltage: 500 VDC
 Insulation voltage: 500 VAC
 Rated resistance: E3 Series; optional E6 Series
 • linear law: 220R to 4M7
 • non-linear law: 470R to 2M2
 Tolerance on rated resistance:
 • 220R to 1M0: $\pm 20\%$
 • over 1M0: $\pm 30\%$
 Resistance law: A, B, C, F, S, T, X
 • with tap: A2, B2, C2, S2

Stereo types

Matching: class II
 • optional: class I

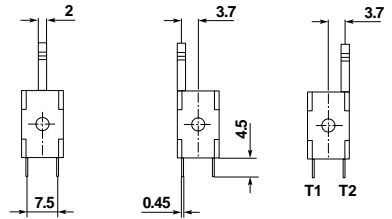
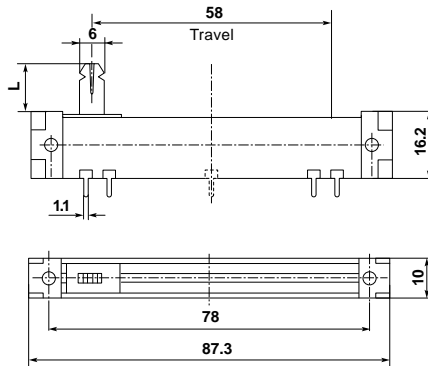

Central spindle Left spindle Right spindle

View from the beginning of travel side

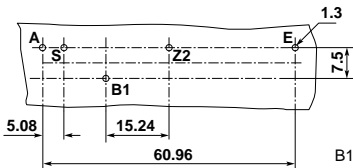

B1 = additional fixing tag

CIPGST 2.58M

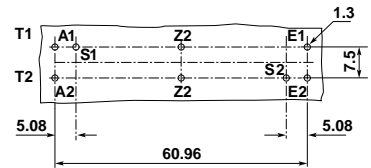

CIPGST 2.58S



Looking the potentiometer with terminations down, from the side with the marking, terminal A1 is situated on the left of opposite side.



Carbon Slider Potentiometers

58 mm travel

Types
CIPGST 2.58M
PGST 2.58M
CIPGST 2.58S
PGST 2.58S

Single types

CIPGST 2.58M	P.c. terminations
PGST 2.58M	Solder tag terminations

Stereo types

CIPGST 2.58S	P.c. terminations
PGST 2.58S	Solder tag terminations

Standard types

P.c. terminations: **CIPGST 2.58 0100M**
 Solder tag terminations: **PGST 2.58 0100M**

Standard types

P.c. terminations: **CIPGST 2.58 0100S**
 Solder tag terminations: **PGST 2.58 0100S**

Fixing nut variations

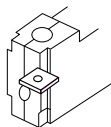

Pos. 1

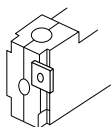

Pos. 2

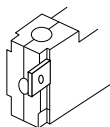

Pos. 3

M3 screws mounting from: top or bottom (Pos. 1), small vertical sides (Pos. 2), front or back (Pos. 3)

Spindle variations

Plastic
 Thickness 2 mm

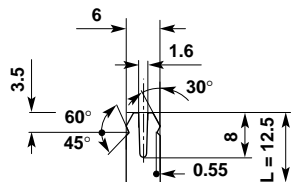

Spindle type 7
 Standard

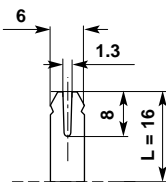

Spindle type 8
 Optional

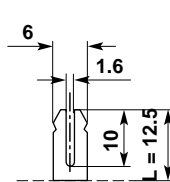

Spindle type 9
 Optional

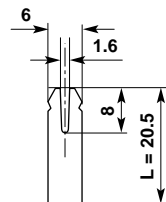

Spindle type 10
 Optional

Ordering numbers

(CI) PGST 2.58 X X 0 X M
 (CI) PGST 2.58 X X 0 0 S

- 0 - Central spindle type 7
- 1 - Left spindle type 7
- 2 - Right spindle type 7
- 3 - Central spindle type 8
- 4 - Left spindle type 8
- 5 - Right spindle type 8
- 6 - Central spindle type 9
- 7 - Left spindle type 10
- 8 - Right spindle type 10

- Single types only
- 0 - Without additional fixing tag
- 2 - With additional fixing tag
- 0 - Without nuts
- 1 - Nuts pos. 1
- 2 - Nuts pos. 2
- 3 - Nuts pos. 3